



## FORCE™ POWER DIRECT VENT

The SDV75-76 Force tank-type commercial gas water heater is intended for light-duty applications such as small office buildings and duplex apartment homes. The SDV75-76 Force features a power direct-vent design, with a factory-installed blower. The blower permits sealed combustion direct-vent operation, with separate venting and air intake runs from outside the structure. The SDV75-76 Force offers installation versatility by allowing venting and intake runs up to 50 equivalent feet, using 3" Schedule 40 PVC pipe.

The power direct-vent design also eliminates the potential for performance and safety problems caused by negative air pressure, a problem found in many commercial applications with inadequate indoor ventilation.

### TURBO-FORCE DIP TUBE

- Helps reduce lime and sediment buildup and maximizes hot water output. Made from long-lasting PEX cross-linked polymer

### BLUE DIAMOND® GLASS COATING

- Provides superior corrosion resistance compared to the industry-standard glasslining.

### HOT SURFACE IGNITION

- Has a solid state ignition surface that does not flutter or blow out.
- Provides increased reliability and efficiency over spark ignition systems. Eliminates the pilot and saves energy.

### ENHANCED-FLOW BRASS DRAIN VALVE

- Have a solid brass, tamper resistant, enhanced flow, ball type, drain valve.
- Uses a standard female hose fitting that allows for fast and easy draining during maintenance.
- Designed for easy operation, this valve includes an integral screwdriver slot that features a ¼ turn (open/close) radius, which not only permits full straight through water flow but also a quick and positive shut off.

### CSA CERTIFIED AND ASME RATED T&P RELIEF VALVE

### MAXIMUM HYDROSTATIC WORKING PRESSURE 150 PSI

### STANDARDS

- Design-certified by CSA International, according to ANZI Z21.10.3 - CSA 4.3 standards governing storage-type water heaters.
- Meets the thermal efficiency and standby loss requirements of the U.S. Department of Energy and current edition of ASHRAE/IESNA 90.1.

### POWERED DIRECT VENTING

- Provides more venting flexibility.
- Roof or sidewall venting with 3" or 4" PVC, CPVC, ABS or polypropylene.
- Allowable vent lengths of up to 125 equivalent feet make installation easy in any situation.

### QUIET MODULAR BLOWER

- Built-in safety device prevents pilot or main burner operation if blower is not operating.
- Blower has 100/120V electrical system, with maximum 2-amp draw.

### 3-YEAR LIMITED TANK / 1-YEAR LIMITED PARTS WARRANTY

- For complete warranty information, consult written warranty or contact [StateWaterHeaters.com](http://StateWaterHeaters.com).



SDV75 76 SERIES 210/211



Low Lead Content



# SOLID. STATE.

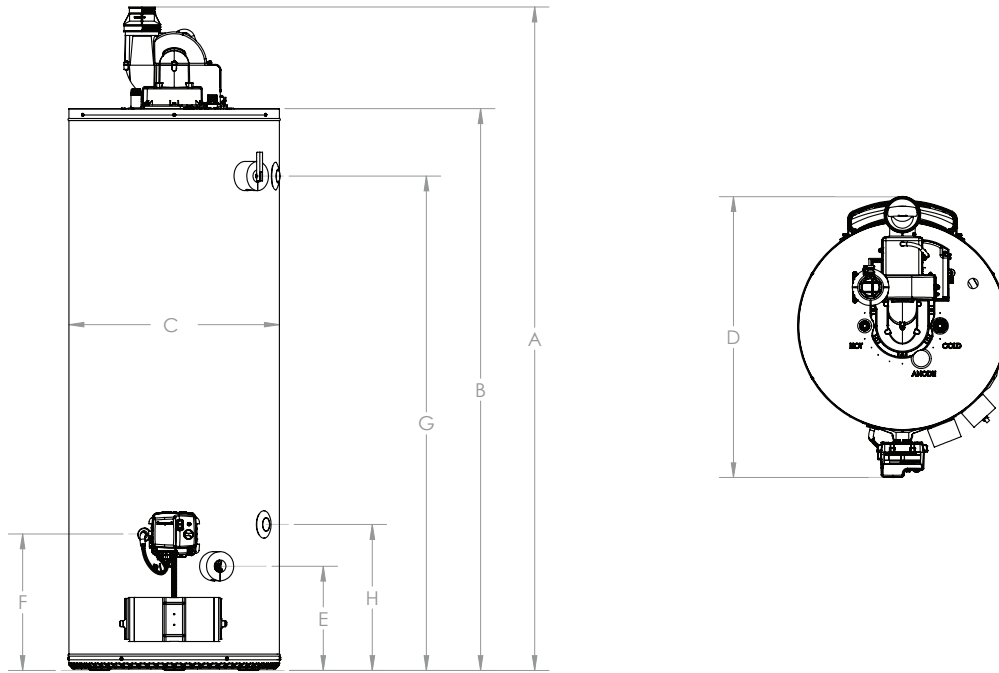

**DIMENSIONS**

Model Number	Dimensions in Inches								Water Connections	Gas Connection	Approx. Shipping Weight
	A	B	C	D	E	F	G	H			
SDV75 76NE	70-5/8	61-1/4	26	33-1/8	11	13-1/4	53	15-1/4	3/4" NPT	1/2" NPT	277 lbs

Dimensions and specifications subject to change without notice in accordance with our policy of continuous product improvement.

**RECOVERY CAPACITIES**

U.S. GALLONS/HR. AND LITRES/HR. AT TEMPERATURE RISE INDICATED

Model Number	Input		Approx. Capacity		°F	30°F	40°F	50°F	60°F	70°F	80°F	90°F	100°F	110°F	120°F	130°F	140°F
	Btuh	kW	U.S. Gals.	Litres	°C	17°C	22°C	28°C	33°C	39°C	44°C	50°C	56°C	61°C	67°C	72°C	78°C
SDV75 76NE	76,000		75		GPH	246	185	148	123	106	92	82	74	67	62	57	53
		22.3		280	LPH	932	699	559	466	400	350	311	280	254	233	215	200

Available in LP (Propane) gas. Change N to P in model number.  
Can be installed up to 10,100 feet without alteration.

**SAMPLE SPECIFICATION**

Water Heater(s) shall be model SDV75-70 Force™ as manufactured by State Water Heaters shall be of glasslined design, and gas-fired, equipped to burn \_\_\_\_\_ gas and design certified by Underwriters Laboratories under Volume III tests for commercial heaters for delivery of 180°F water, and meets the thermal efficiency and standby loss requirements of the U. S. Department of Energy and current edition of ASHRAE/IESNA 90.1. Heaters shall have an input rating of \_\_\_\_\_ and a recovery rating of \_\_\_\_\_ GPH at a temperature rise of 100°F with a storage capacity of 75 gallons.

Unit(s) shall be direct-vent design, with an automatic blower-powered, two-pipe air intake and exhaust system communicating directly with the outside of the building. The blower shall have a safety device that will not allow the operation of the main burners unless the blower is in operation. Unit(s) shall have a combustion air passage that is internal to the outer jacket of the water heater other than the intake and exhaust connections at the top of the water heater.

Heater tank shall have a 3-year limited warranty against corrosion or sediment buildup as outlined in the written warranty. Fully illustrated instruction manual to be included.

FOR MORE INFORMATION, CONTACT: STATE WATER HEATERS 500 TENNESSEE WALTZ PARKWAY, ASHLAND CITY, TN 37015 800-365-0024 TOLL-FREE USA STATEWATERHEATERS.COM